

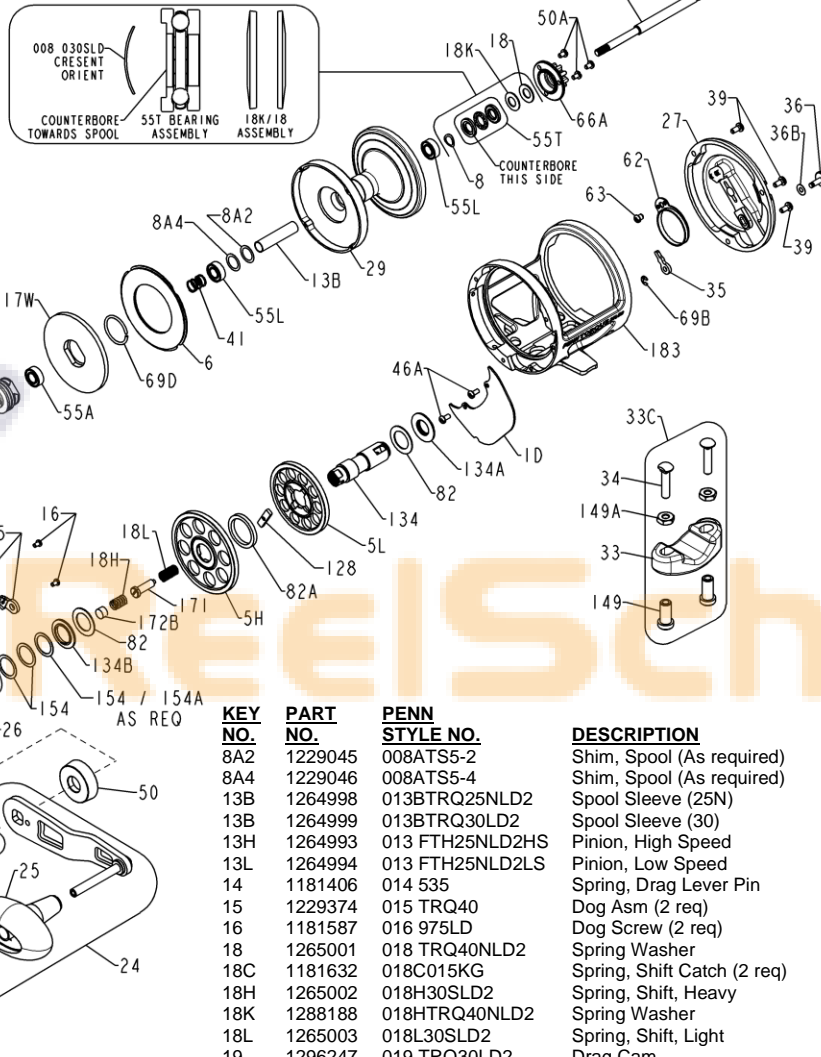

MODELS TRQ25NLD2G (Gold), 1206028 & TRQ25NLD2S (Silver), 1501852

TRQ30LD2G (Gold), 1206069 & TRQ30LD2S (Silver), 1501853

MODEL SHOWN IS TRQ30LD2



KEY NO.	PART NO.	PENN STYLE NO.	DESCRIPTION
1	1264961	001 TRQ30LD2G	R.S. Plate Asm (Gold)
1	1500548	001 TRQ30LD2S	R.S. Plate Asm (Silver)
1D	1264968	001DTRQ30LD2G	Gear Cover (Gold)
1D	1500540	001DTRQ30LD2S	Gear Cover (Silver)
2	1264971	002 TRQ30LD2B	Quadrant
2A	1264976	002ATRQ30LD2	Drag Lever Ratchet
4	1264978	004 TRQ15LD2	Washer, Drag Lever
5H	1264981	005 FTH25NLD2HS	Gear, High Speed Main
5L	1264982	005 FTH25NLD2LS	Gear, Low Speed Main
6	1264986	006 TRQ30LD2	Drag Washer
8	1257843	008 030SLD	Washer, Crescent

KEY NO.	PART NO.	PENN STYLE NO.	DESCRIPTION
8A2	1229045	008ATS5-2	Shim, Spool (As required)
8A4	1229046	008ATS5-4	Shim, Spool (As required)
13B	1264998	013BTRQ25NLD2	Spool Sleeve (25N)
13B	1264999	013BTRQ30LD2	Spool Sleeve (30)
13H	1264993	013 FTH25NLD2HS	Pinion, High Speed
13L	1264994	013 FTH25NLD2LS	Pinion, Low Speed
14	1181406	014 535	Spring, Drag Lever Pin
15	1229374	015 TRQ40	Dog Asm (2 req)
16	1181587	016 975LD	Dog Screw (2 req)
18	1265001	018 TRQ40NLD2	Spring Washer
18C	1181632	018C015KG	Spring, Shift Catch (2 req)
18H	1265002	018H30SLD2	Spring, Shift, Heavy
18K	1288188	018HTRQ40NLD2	Spring Washer
18L	1265003	018L30SLD2	Spring, Shift, Light
19	1296247	019 TRQ30LD2	Drag Cam
21	1265005	021 TRQ30LD2G	Drag Lever (Gold)
21	1265006	021 TRQ30LD2S	Drag Lever (Silver)
21A	1265011	021ATRQ30LD2	Lever/Quadrant Spacer
23	1229458	023 012VS	Handle Screw
23L	1191283	023L750	Handle Knob Screw
23W	1286986	023WTRQ40NLD2	Handle Nut Washer
24	1277509	024 TRQ30LD2G	Handle Asm (Gold)
24	1500021	024 TRQ30LD2S	Handle Asm (Silver)
24C	1191335	024C066	Handle Knob Cap
25	1240293	025 TRQ40	Handle Knob
26	1265023	026 TRQ40NLD2	Ball Bearing (2 req)
26N	1435256	026NS025	Ball Bearing
27	1265032	027 TRQ30LD2G	Plate, L.S. (Gold)
27	1500639	027 TRQ30LD2S	Plate, L.S. (Silver)
29	1265039	029 TRQ25NLD2G	Spool (25N) (Gold)
29	1500629	029 TRQ25NLD2S	Spool (25N) (Silver)

KEY NO.	PART NO.	PENN STYLE NO.	DESCRIPTION
29	1265041	029 TRQ30LD2G	Spool (30) (Gold)
29	1500631	029 TRQ30LD2S	Spool (30) (Silver)
32	1265049	032 TRQ15LD2S	Screw, Flat Head
33	1290729	033 TRQ	Rod Clamp
33C	1290731	033CTRQ40NLD2	Rod Clamp Kit
34	1182788	034 045	Screw, Rod Clamp (2 req)
35	1188656	035 20	Click Tongue
36	1265053	036 TRQ40NLD2S	Click Button
36B	1188651	036B20	Spacer, Click Button
38	1293254	038 TRQ40SN	Screw, Locking (3 req)
38A	1265055	038 TRQ40NLD2S	Screw (2 req)
39	1293255	039 TRQ40SN	Screw, Locking (3 req)
39S	1183261	039S965	Screw, Cover (4 req)
41	1265056	041 TRQ40NLD2	Spring, Drag
46A	1183585	046A4300	Screw, Cover (2 req)
50	1265058	050 TRQ15LD2G	Gear Shield (Gold)
50	1500545	050 TRQ15LD2S	Gear Shield (Silver)
50A	1183767	050 716	Screw, Ratchet (3 req)
52	1183840	052 910	Retaining E-Ring (2 req)
55A	1238912	055A50SLD	Ball Bearing
55L	1286985	055L020	Ball Bearing (2 req)
55T	1238913	055T30SLD	Bearing Assembly
62	1184026	062 209	Click Spring
62A	1236596	062 TRQ40	Spring, Strike Button
63	1184048	063 209	Screw, Click Spring
66A	1265059	066AFTHLD	Click Ratchet
67	1184105	067 030VS	Retaining E-Ring, Shift
69B	1184125	069B050	Retaining E-Ring, Click
69D	1265060	069DFTH15LD	Retaining Ring, Drag
71	1265063	071 TRQ25NLD2	Spindle (Assembly)(25N)
71	1265065	071 TRQ30LD2	Spindle (Assembly)(30)
82	1265070	082 TRQ40NLD2	Washer, Teflon (2 req)
82A	1265071	082A30SLD2	Washer, Gear Separating
91A	1277514	091ATRQ40NLD2	Handle Knob Washer
98	1265073	098 FTH40NLD2	Dog Ratchet
110A	1230438	110A012VS	Handle Screw Lock Ring
110B	1264940	110BTRQ40NLD2S	Shifter Base
110C	1264941	110C012VSS	Shift Button Ring
117	1265076	117 TRQ40NLD2	Drive Plate Hub
117S	1265080	117STRQ40NLD2	Drag Cover Seal
117W	1265082	117WTRQ30LD2	Drag Washer
128	1265084	128 30SLD2	Shift Key
133	1230583	133 12VS	Retaining Plate
134	1265085	134 30SLD2	Gear Stud
134A	1265086	134A30SLD2	Gear Stud Nut
134B	1265087	134B30SLD2	Gear Spacer
141	1265088	141 TRQ15LD2	Cam Follower
141B	1265089	141BTRQ15LD2	Spring, Preset Knob
144	1265091	144 TRQ15LD2S	Preset Knob
149	1184702	149 045	Rod Clamp Nut (2 req)
149A	1184706	149 200	Hex Nut (2 req)
154	1265092	154 TRQ40NLD2	Shim, .010 (2 + As Req)
154A	1306668	154ATRQ40NLD2	Shim, .004 (As required)
156	1265094	156 TRQ30LD2	Drag Cover
161	1265097	161 TRQ40NLD2	Pin, Free Locating
161A	1265098	161ATRQ15LD2	Pin, Lever Click
161B	1265099	161BTRQ40NLD2	Strike Button
162	1318280	162 TRQ40NLD2	Spring, Free Button
171	1265101	171 30SLD2	Shift Plunger (Screw)
172	1265104	172 012VSG	Shift Button (Gold)
172	1500539	172 012VSS	Shift Button (Silver)
172B	1184831	172B030VS	Shift Spacer
173	1192384	173 012VS	Shifter Catch (2 req)
173A	1230664	173A012VS	Shift Catch Holder
183	1265111	183 TRQ25NLD2G	Frame (25N) (Gold)
183	1500547	183 TRQ25NLD2S	Frame (25N) (Silver)
183	1265114	183 TRQ30LD2G	Frame (30) (Gold)
183	1500640	183 TRQ30LD2S	Frame (30) (Silver)
195	1184955	195 040	Gear Stud Ret. E-Ring